

QA3™

Patient Stretcher

Compact, light weight and manoeuvrable
the complete solution for patient transport



Innovative Medical Technology - **Practically Applied**

AneticAid®

QA3 PATIENT STRETCHER SYSTEM

QA3///DRIVE™ Powered ⚡ Patient Stretcher

STANDARD FEATURES plus INBUILT MOTORISED DRIVE and POWERED FUNCTIONS

Top of the range model: combines all features of the Standard, DRIVE and Powered Stretchers – the complete answer for moving and positioning patients as easily as possible.

Description	Code
QA3 DRIVE Powered Patient Stretcher	21114



Drive handles

Innovative touch sensitive design simply press against the pop-up or fixed yellow pushing handles, and the trolley will move forward; pull back on them, and it will reverse; let go and it will stop.



Electrically Powered Functions

Easy to operate using the positive feel push button controls on a panel at the foot of the stretcher.

Manual override systems as standard.

Three new models to choose from

QA3///DRIVE™ Patient Stretcher

STANDARD FEATURES plus INBUILT MOTORISED DRIVE

Featuring inbuilt motorised drive – operated by innovative touch-sensitive pushing handles: controlled, effortless travel up to gradients of 10°.

Description	Code
QA3 DRIVE Patient Stretcher	21112



QA3™ Patient Stretcher

STANDARD FEATURES

Ideal for patient transport, examination and intubation in theatre and clinical areas: supremely manoeuvrable, compact, light weight and robust with maximum patient comfort built in.

Description	Code
QA3 Patient Stretcher	21110



LIFETIME WARRANTY
Subject to annual servicing



QA3™ Patient Stretcher:

We offer the unique
and popular
'Lifetime Warranty Scheme'

Take out a **AnetiCare** service package for regular and predictable maintenance costs that includes a **10 YEAR WARRANTY**.

Covers engineer's time and most parts contact us to learn more about what an **AnetiCare** service package can offer you.

Available via your Anetic Aid partner – find them at aneticaid.com/distributors.

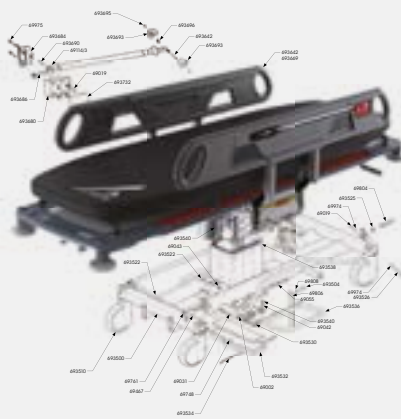

Combining industry knowledge with
innovative technology



Designed and produced at our UK manufacturing
facility using the latest engineering techniques



Manufacturer, designer and supplier of high quality
medical equipment around the world



Unique manufacturer-backed Lifetime Warranty Scheme

STANDARD FEATURES

Supremely manoeuvrable, compact, light weight and robust with maximum patient comfort built in: ideal for patient transport, examination and intubation in theatre and any other clinical area.

With the backrest raised, it is little more than 1.8m long and it descends lower and is narrower and shorter than nearly all other patient stretchers on the market.



Trendelenburg tilt

Extremely smooth and controlled mechanism, even at lowest height

Vertically operated side rails

Store away under mattress for a virtually zero transfer gap. Spring counterbalancing allows effortless ease of operation

5th wheel steering

Unique mechanism ensures maximum manoeuvrability and easily guided by one person

Patient comfort

Exceptional low height capability and store away side rails allow easy mount/dismount particularly for frail and elderly patients. Wide patient platform and pressure care mattress for patient comfort. Optimum ground clearance for patient hoist access



Pushing handles

Four ergonomically positioned pushing handles for supreme manoeuvrability

Gas assisted backlift

Unique design, precision controlled, easy lift system for enhanced user and patient comfort



K8 pressure care mattress

Manufactured from temperature-sensitive gel feel foam that moulds to the patient's body shape, relieving pressure by distributing the load as evenly as possible. Outer material is anti-microbial, water resistant, vapour permeable and latex free

Infection control

Smooth moulded surfaces and acrylic capped vac formings enclose stretcher mechanics to minimise dirt traps. Anti-bacterial properties and innovative design for easy cleaning

Fixed transfusion pole

Innovative quick release safety locking mechanism, integrates into either head or foot end of side rails for easy access and storage

Hydraulic lift mechanism

Exceptional low height capability, adjusted by independently operating pedals on both sides of stretcher



Castors

Polyurethane tyres offer low rolling resistance for high manoeuvrability, 150mm castors fitted as standard, 200mm optional

Cylinder trough

Side loading for ease of access, suitable for wide range of cylinder options including F, E or CD

Robust with maximum patient comfort built in



DESIGN & INNOVATION



MADE IN THE UK



GLOBAL DISTRIBUTION

Motorised **DRIVE** FEATURES

QA3 **DRIVE**TM
Powered Patient Stretcher

QA3 **DRIVE**TM
Patient Stretcher

QA3TM
Patient Stretcher

Inbuilt motorised drive offers effortless movement combined with ultimate control.

Because people and therefore patients are getting larger, it's crucial that we take moving and handling issues into account, giving practitioners a stretcher on which patients can be moved and positioned as easily as possible.

The introduction of our new touch-activated, motorised DRIVE feature offers a major enhancement in a Stretcher that already has ease of use, practicality and patient comfort built in.

The Stretcher can also be used in traditional fifth wheel steer mode.

Effortless travel up to gradients of 10°

Inbuilt motorised drive

No need to push or pull the stretcher: our new, inbuilt motorised DRIVE feature linked to the stretcher's 5th wheel, offers controlled, effortless travel up to gradients of 10°.



Drive handles

Innovative touch sensitive design simply press against the pop-up or fixed yellow pushing handles, and the stretcher will move forward; pull back on them, and it will reverse; let go and it will stop.



Long-life battery – 22 kilometers on a single charge

DRIVE feature powered by advanced nickel metal hydride rechargeable battery.



Highly accurate battery charge indicator – rapid charge.



DESIGN & INNOVATION



MADE IN THE UK



GLOBAL DISTRIBUTION

Motorised DRIVE: effortless travel, ultimate control

Powered ⚡ FEATURES



Minimise risks for practitioners dealing with increasing patient weights with powered positioning: the whole Stretcher platform or the backrest can be raised or lowered electronically from the panel at the foot end.



An additional powered feature places the Stretcher into the Kneeflex position for easy elevation of the lower limbs for patients having leg and foot procedures – position also provides additional comfort, particularly for patients undergoing abdominal procedures.

There's also a special CPR feature: return the stretcher swiftly to a horizontal, optimal height position for CPR treatment.

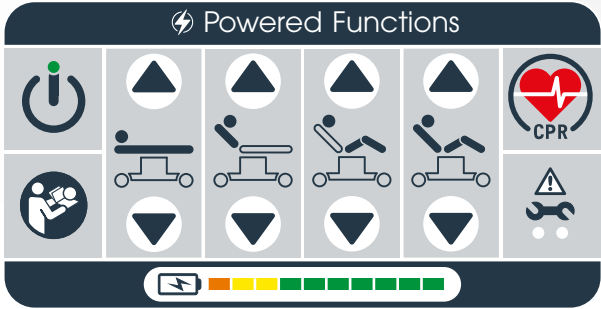

Electrically Powered Functions
Easy to operate using the positive feel push button controls on a panel at the foot of the stretcher.
Manual override systems as standard.

Platform height – electrically powered raise and lower mechanism

Offers smooth movement to position the stretcher at any point in its height range – 475mm to 775mm (excluding mattress).



Backrest – electrically powered raise and lower mechanism

Positions the backrest anywhere between the vertical and horizontal for maximum patient comfort.



Lights on the power panel illuminate to refer the user to the manual if the equipment is being used incorrectly or to indicate when maintenance is required

If a patient needs CPR treatment, there is no time to lose: the powered CPR feature returns the stretcher swiftly to a horizontal, optimal height position for CPR treatment.

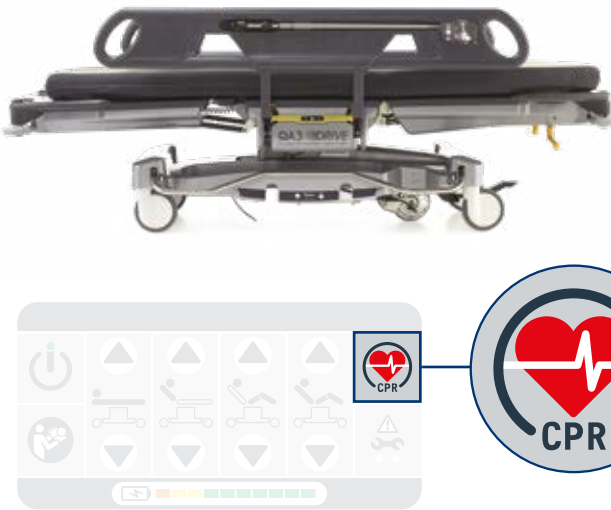

Trendelenburg – hydraulically powered tilt mechanism

Extremely smooth and controlled movement, even at the stretcher's lowest height.



Our top of the range model combining all the features of the Standard, Drive and Powered stretchers.



ACCESSORIES

K8 Pressure Care Mattresses

Pressure care and infection control are top priorities in a stretcher mattress – and Anetic Aid’s independently tested K8 pressure care mattress addresses both of these vital factors.

At its core is high density foam, uniquely specified by Anetic Aid. This means that the mattress can be thinner, while still offering the same, if not better, pressure distribution than a thicker, less sophisticated foam. This is particularly important with tables and Stretchers, as it means the overall height can be kept as low as possible for easy access by frail or elderly patients.

A layer of thermally responsive gel-feel memory foam is then added, further relieving pressure by distributing the patient’s weight as evenly as possible across the surface area – whatever their position.



In the science of Kinetics, there are eight points of contact the human body makes when lying on a hard surface – hence K8.

Description	Code
QA3 K8 Pressure Care Mattress with Zip Cover	21186
QA3 K8 Pressure Care Mattress – Replacement Waterproof Zip Cover	21186-B1



Anetic Aid’s K8 technology mattresses can be found in over 90% of NHS hospitals in the UK.

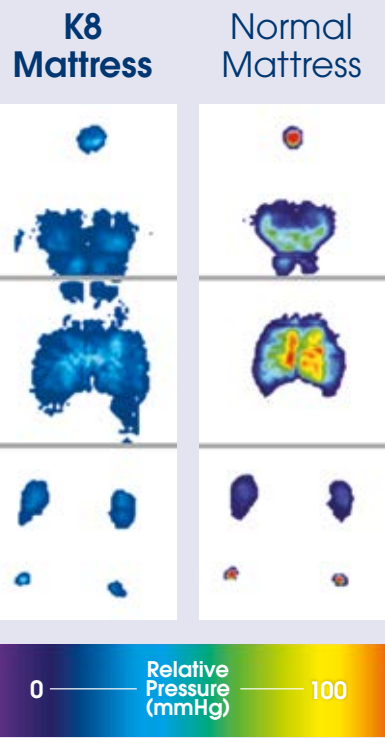

High risk pressure care mattress

Independently tested

Latex free

Antibacterial / vapour permeable

Welded seams

X-ray translucent

Infection control

Both of the foam elements of the mattress have antibacterial and microbial fungistatic properties – but Anetic Aid goes further, adding a latex-free, 4-way stretch polyurethane (PU) outer cover to each mattress (most materials being 2-way stretch), which is anti-microbial, water resistant and vapour permeable.

This means it is not only contamination-resistant, but it also allows the skin to breathe – for greater patient comfort.

Finally, a unique ultrasonic sealing system effectively welds the seams of the outer cover material together to give an almost unbreakable seal, making the K8 a class leader in infection control.

QA3//DRIVE™
Powered Patient Stretcher

QA3//DRIVE™
Patient Stretcher

QA3™
Patient Stretcher



Additional products for all QA3 Stretcher models

Specially designed and manufactured accessories for QA3 Patient and Emergency Stretcher Systems.

Description	Code
Monitor Shelf c/w Removable Refreshment Tray	21152
Refreshment Tray ONLY	21152-A1
QA3 Foot-end Extension c/w 100mm Pad	21153
QA3 Side Rail, Endoscopy Height Extension Demi-frame	21165
QA3 Side Rail Covers, Grey (pair)	21172
QA3 Side Rail Covers, Child Print (pair)	21173
Theatre Pillow	10545
QA3 and QA4 Stretcher Systems Push / Pull Bar	21390

Customise the QA3™ to suit your departments requirements with our range of accessories.



OUR PRODUCT AREAS

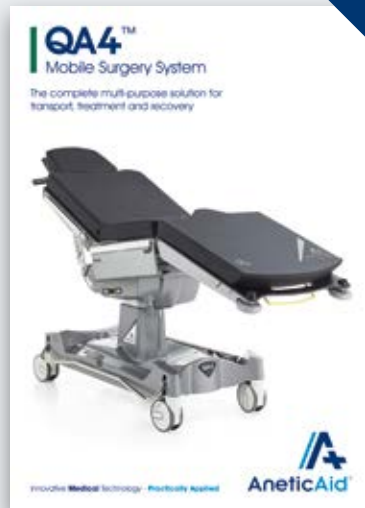

QA4 Mobile Surgery System:

The complete multi-purpose solution for transport, treatment and recovery

PLUS

our other product areas



Scan this code to start a WhatsApp chat with Anetic Aid

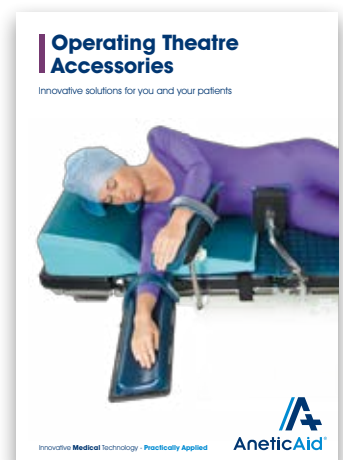

For more information on any of our products or service contracts, call:
sales@aneticaid.com +44 (0)1943 878647 aneticaid.com



DESIGN & INNOVATION



MADE IN THE UK



GLOBAL DISTRIBUTION

Innovative **Medical** Technology - **Practically Applied**

